

VOORGEVEL - 1:100

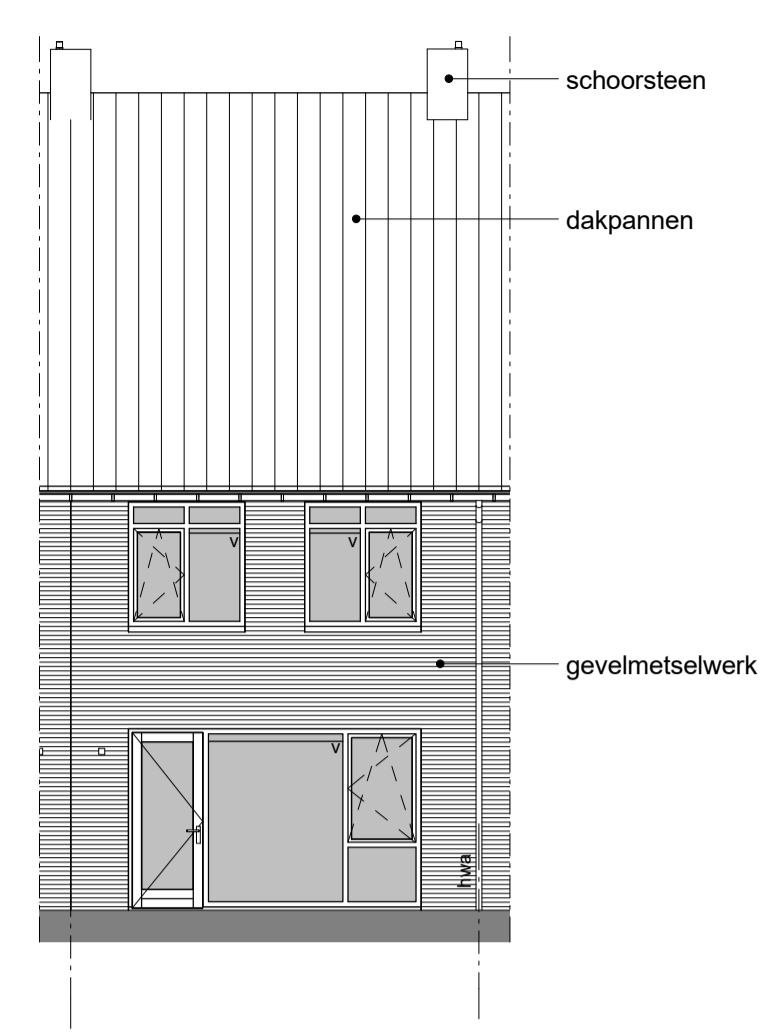

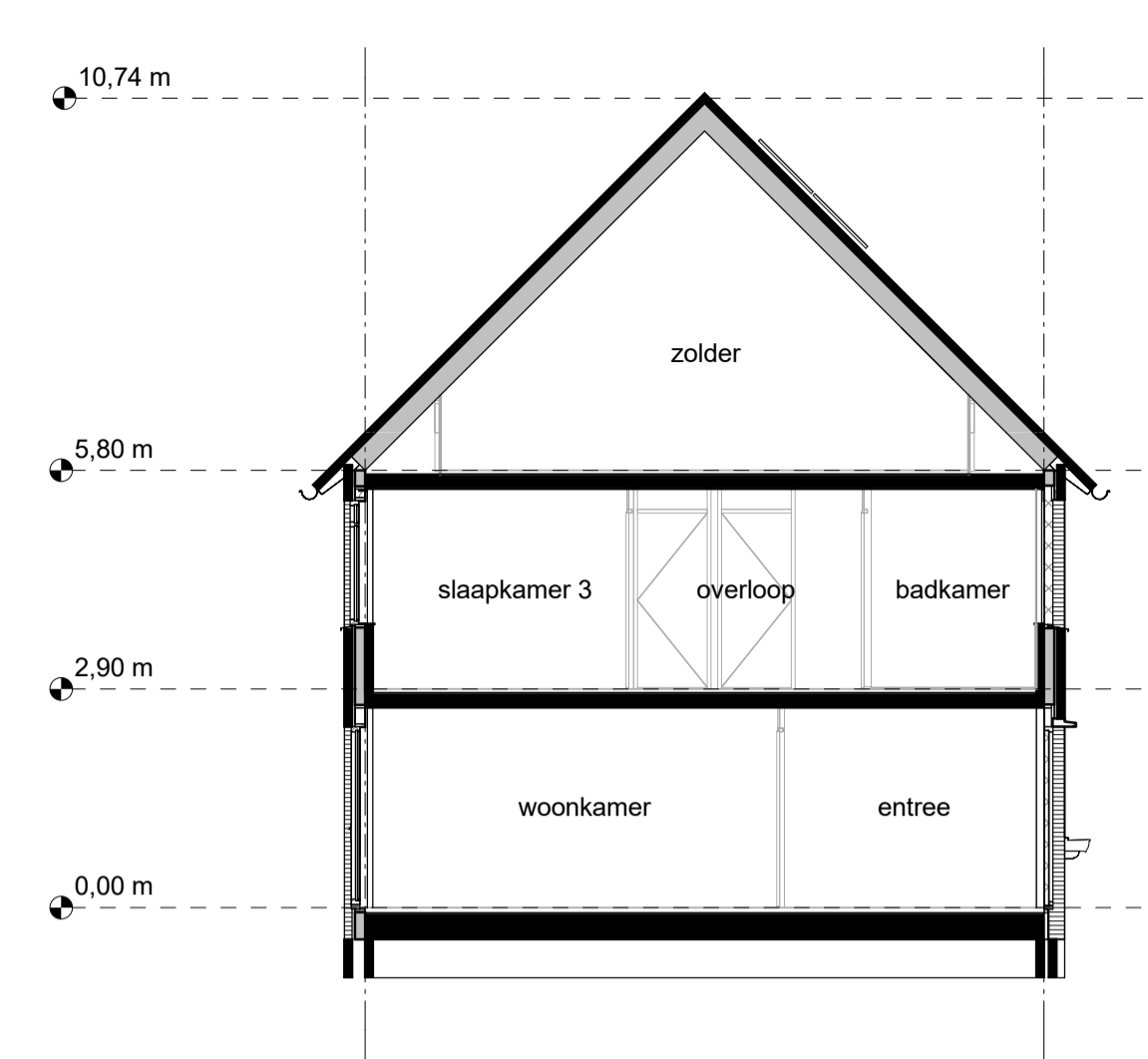









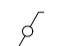



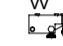

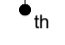

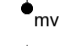

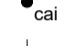
ACHTERGEVEL - 1:100

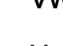

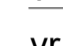
DWARSDOORNSEDE - 1:100

RENVOOI

	enkeelpolige serieschakelaar		perflex wandcontactdoos (voor MV-box)
	enkeelpolige wisselschakelaar		rookmelder
	enkele wandcontactdoos, geaard		radiator
	dubbele wandcontactdoos, geaard		verdeelunit t.b.v. vloerverwarming
	loze leiding, voorzien van trekkoord		CV aansluitpunt of opstelplaats CV-ketel
	thermostaat		MV aansluitpunt/opstelplaats mechanische ventilatie
	hoofdbediening mechanische ventilatie		WM aansluitpunt of opstelplaats wasmachine
	aansluitpunt centrale antenne installatie (CAI)		kk aansluitpunt of opstelplaats koelkast
	aansluiting gas		VW aansluitpunt of opstelplaats vaatwasser
	lichtpunt		V ventilatierooster in het glas
	wandlichtpunt		VR ventilatierooster boven het kozijn
	drukknop voor deurbel		

SITUATIE

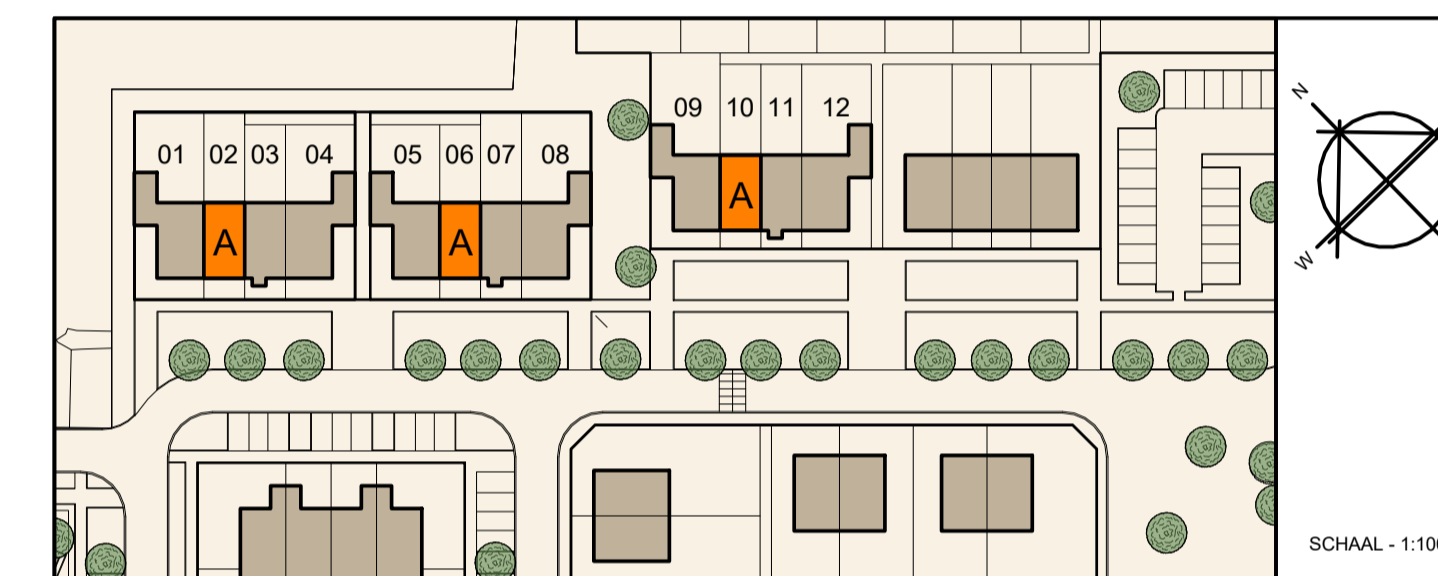

Landelijk wonen in Zwartebroek



NIEUWBOUW 12 RIJWONINGEN DWARSAKKER ZWARTEBROEK

WONINGTYPE A
PLATTEGRONDEN, GEVELS & DOORSNEDEN

BOUWNUMMERS: 02, 06 & 10
DATUM: 18 september 2015
STATUS: definitief

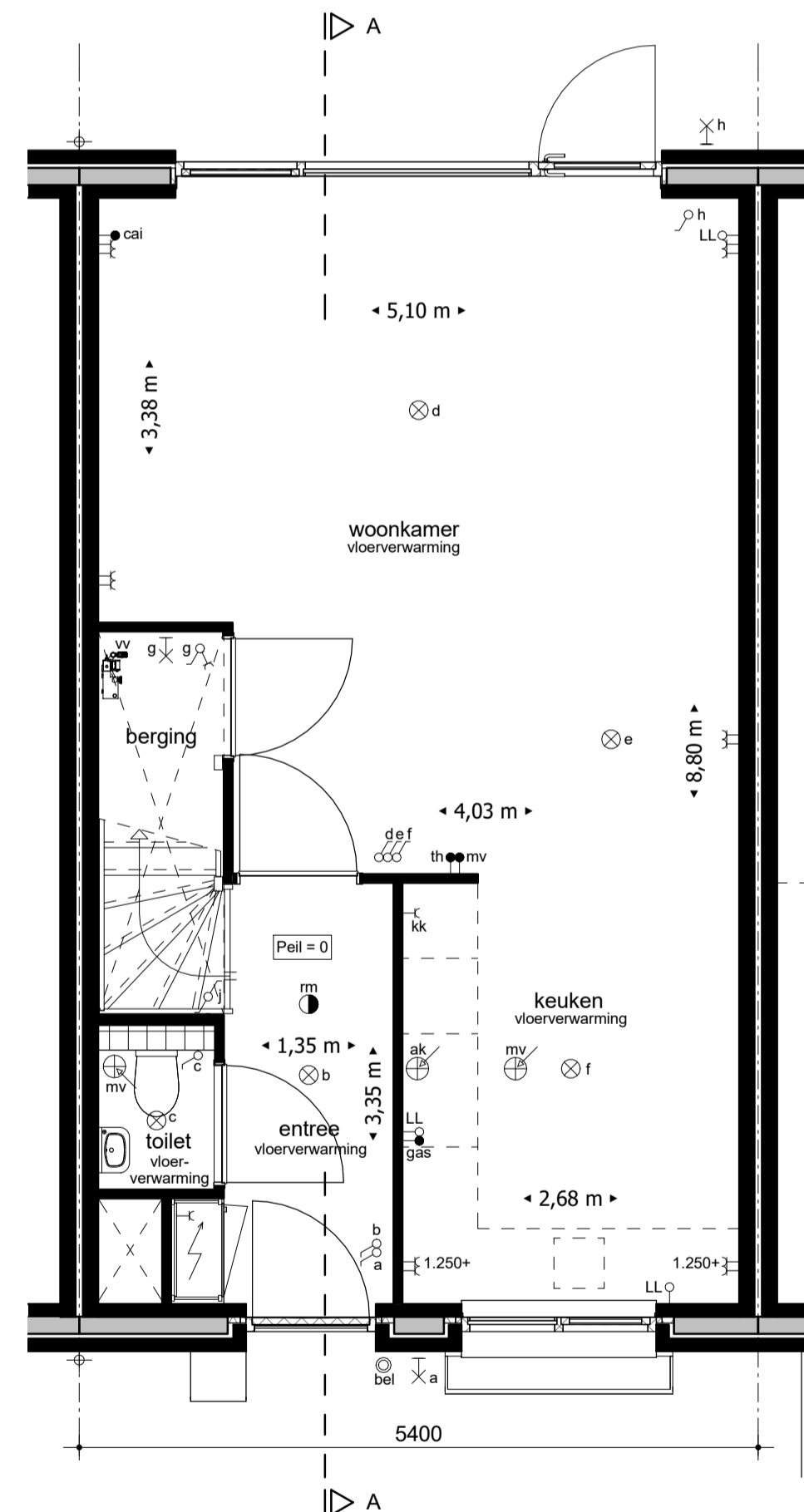

BEGANE GROND - 1:50

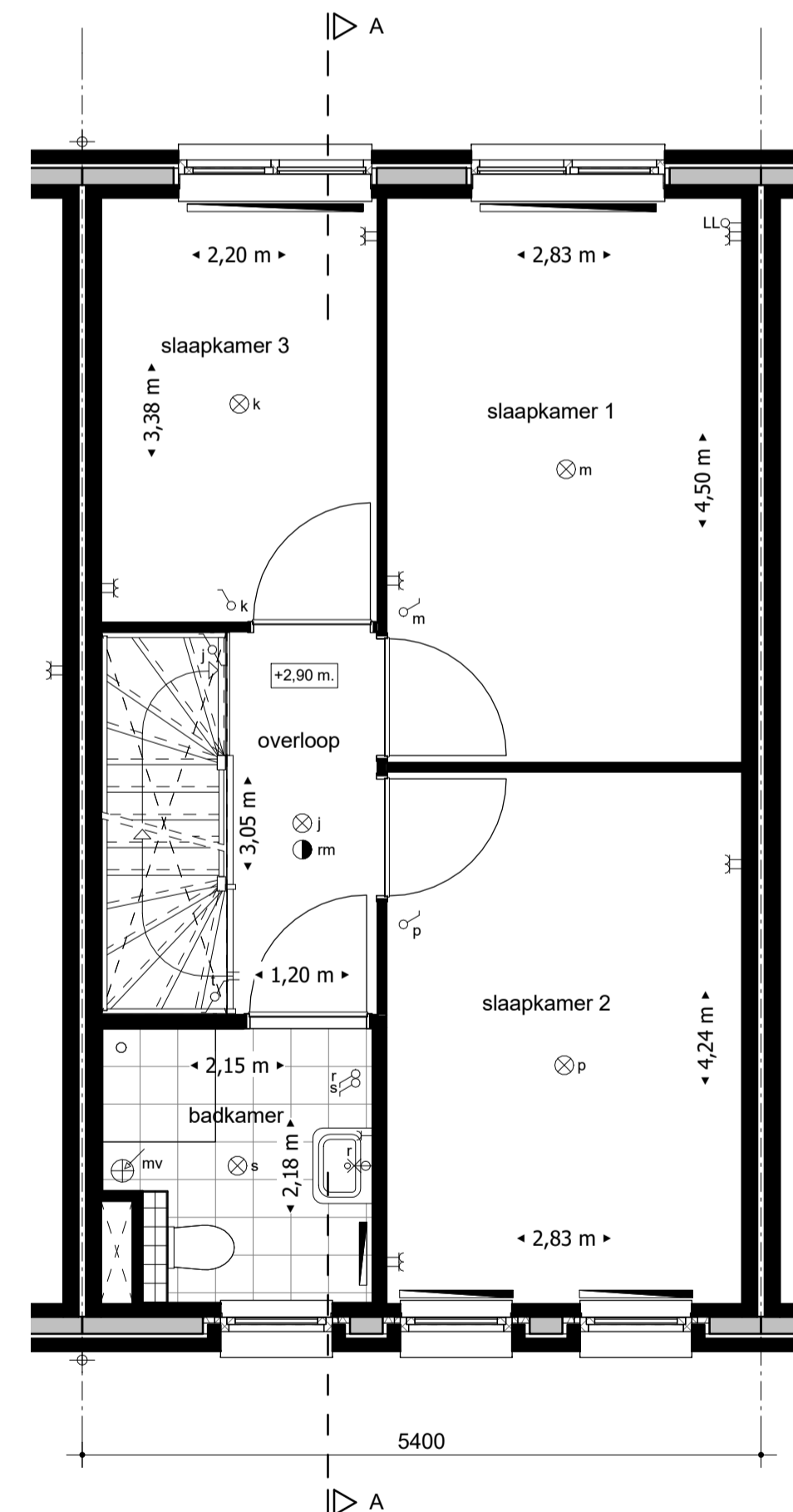

1e VERDIEPING - 1:50

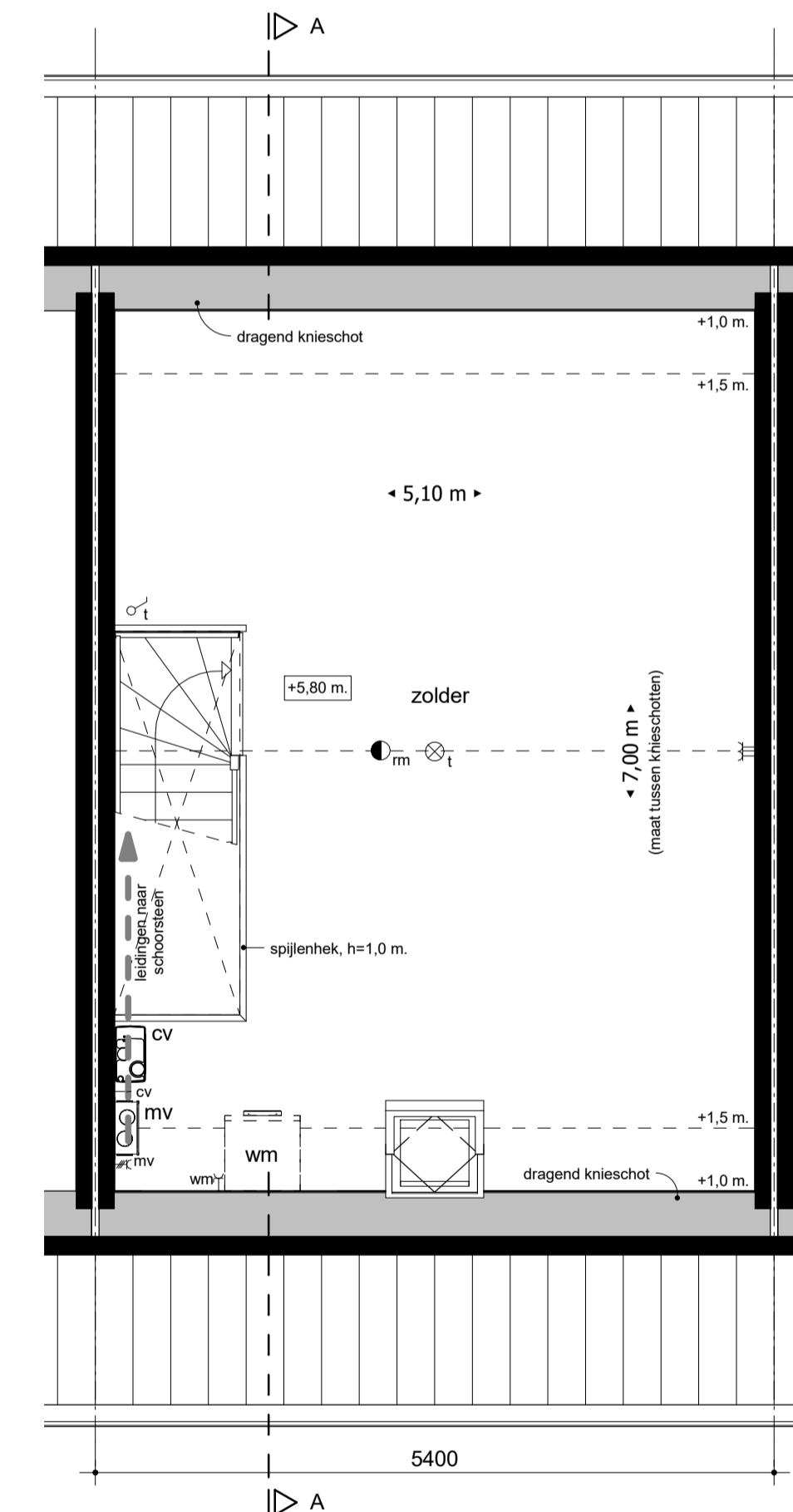

2e VERDIEPING - 1:50